

KEYPLAN

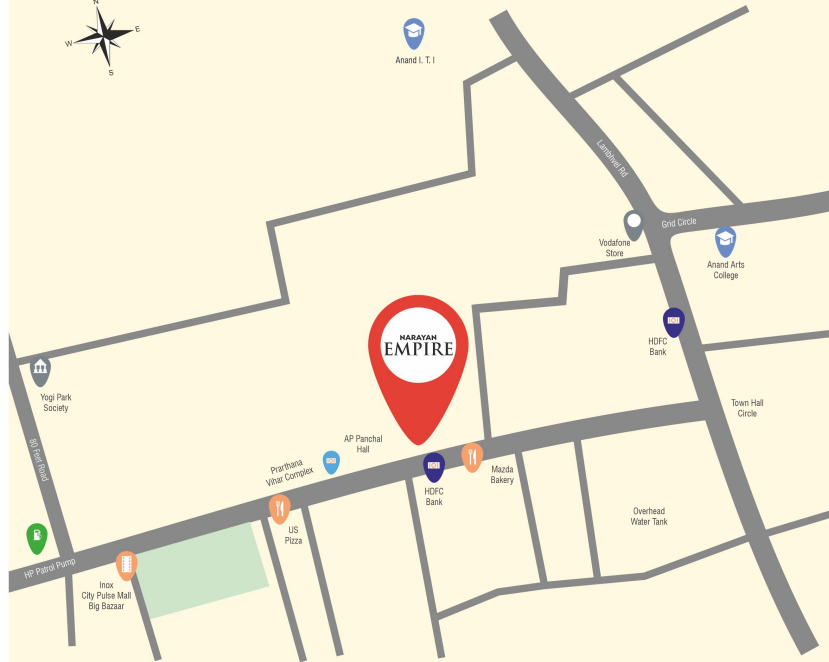

DEVELOPERS: Narayan Buildcon
Site: Old Svayamvar Party Plot,
 Opp. Mazda Bakery, Besides Panchal Hall,
 Anand-Vidhyanagar Road, Anand-388001
Contact: +91 99091 56988, 95746 37667

Project By

NARAYAN
 www.narayan-anand.com

Architect:

Ace Associates
 www.aceassociates.in

Structural Consultant:

AAKAR CONSULTANT
 JAYMIN DESAI
 NADIAD

Payment Schedule:
 10% At the time of Booking | 20% After signing AFS | 15% On Completion of Plinth | 25% On Completion of Slab | 05% On Completion of wall & Plaster
 05% On Completion of Sanitary Fitting | 10% On Completion of Lift & Water Pump | 05% On offer of Possession (30 days before Intimated Possession Date)

Special Notes: 1) Possession will be given after one month of settlement of all accounts. 2) Extra work will be executed after receipt of full advance payment. 3) Document charges, stamp duty, GST & common maintenance charges will be extra. 4) Any new central or state government taxes, if applicable shall have to be borne by the clients. 5) All photography and computer imagery are artist's impression and are provided for illustrative and indicative purposes only. 6) While every reasonable care has been taken in providing this information, the developers cannot be held responsible for any inaccuracy. 7) Subject to Anand Jurisdiction.

PROJECT BY



SHOWROOMS



SHOPS



OFFICES



ALSO
 AVAILABLE ON
 LEASE - RENT





GIVE YOUR BUSINESS
A SUPER PRIME LOCATION
& NEW AGE PREMISES



www.narayan-anand.com

SHIFT OVER TO THE FINEST

Narayan Empire stands proudly at the prime Anand-Vidyanagar road. Designed & crafted with passion, the magistic elevation, the premium finish and the thoughtful planning makes it stand apart from the rest of the buildings surrounding it. Provide your brand maximum visibility, optimum exposure & the true feeling of being in the center of all business activity.

A well planned business center which lets you conduct business in style. Give your business wings with a premium infrastructure and a modern ambience.

Redefining Upscale Retailing & Plush Corporate Spaces!



A PREMIUM PROJECT FROM
ONE OF ANAND'S MOST TRUSTED
NAMES IN REAL ESTATE





YOUR BUSINESS
DESERVES THE
WINNING ADVANTAGE



SPECIAL FEATURES & FACILITIES

- Beautiful landscaping & seating spaces on the ground floor
- A vintage & majestic elevation incorporating artistic configurations
- Wide Corridors & Passages for easy mobility
- 3 High Speed Stretcher lifts
- Power backup for lift & essential common utilities
- Large Concrete / Paved instant parking on ground area with basement parking
- Security of the building backed by CCTV camera at strategic locations
- Anti termite treatment to the building
- All units with attached toilets

SPECIFICATIONS

Structure & Wall Construction

- Earthquake resistant RCC framed structure design
- Internal & External masonry work brick
- Internal wall with putty & primer and external wall with stone cladding / weather proof paint over double coat plaster

Doors & Windows

- Flush door with both side laminate & safety locks / M.S. Rolling Shutter with color
- Powder coated aluminum sliding / glazing operable window

Flooring & Wall Cladding

- Vitrified tile flooring with skirting in all units
- Natural stone / Vitrified tile flooring in common area

Electrical

- Sufficient electric point with concealed wiring along with modular switches of Anchor or equivalent
- 3-Phase Connection on demand



BASEMENT FLOOR PLAN

AMPLE PARKING

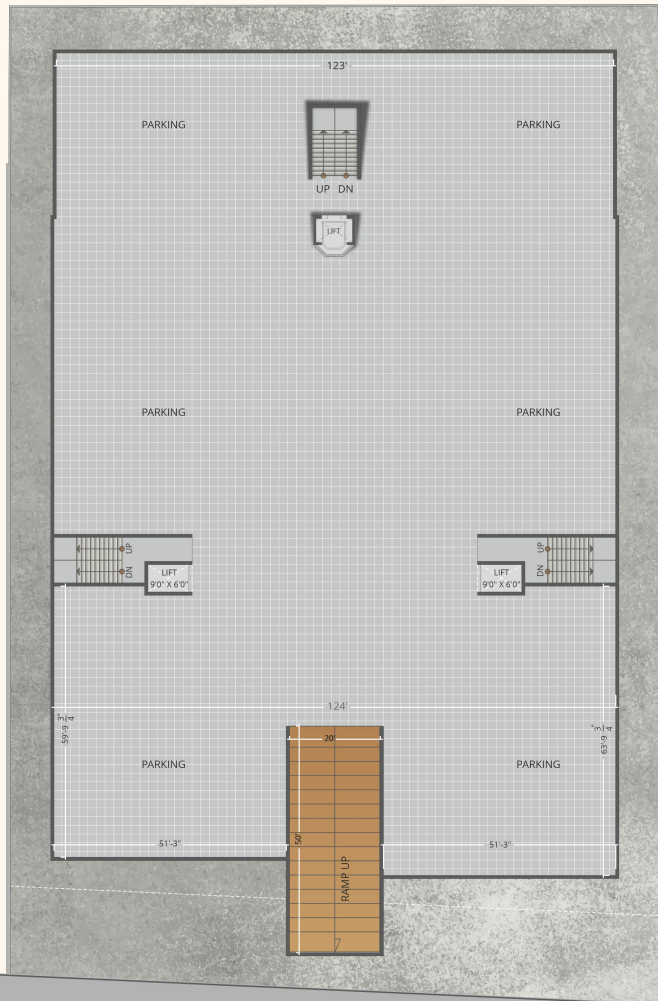

GROUND FLOOR PLAN

AMPLE SPACE

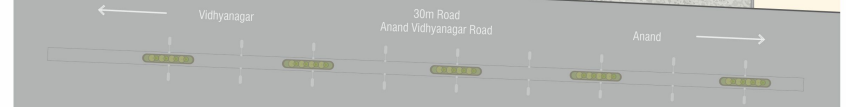
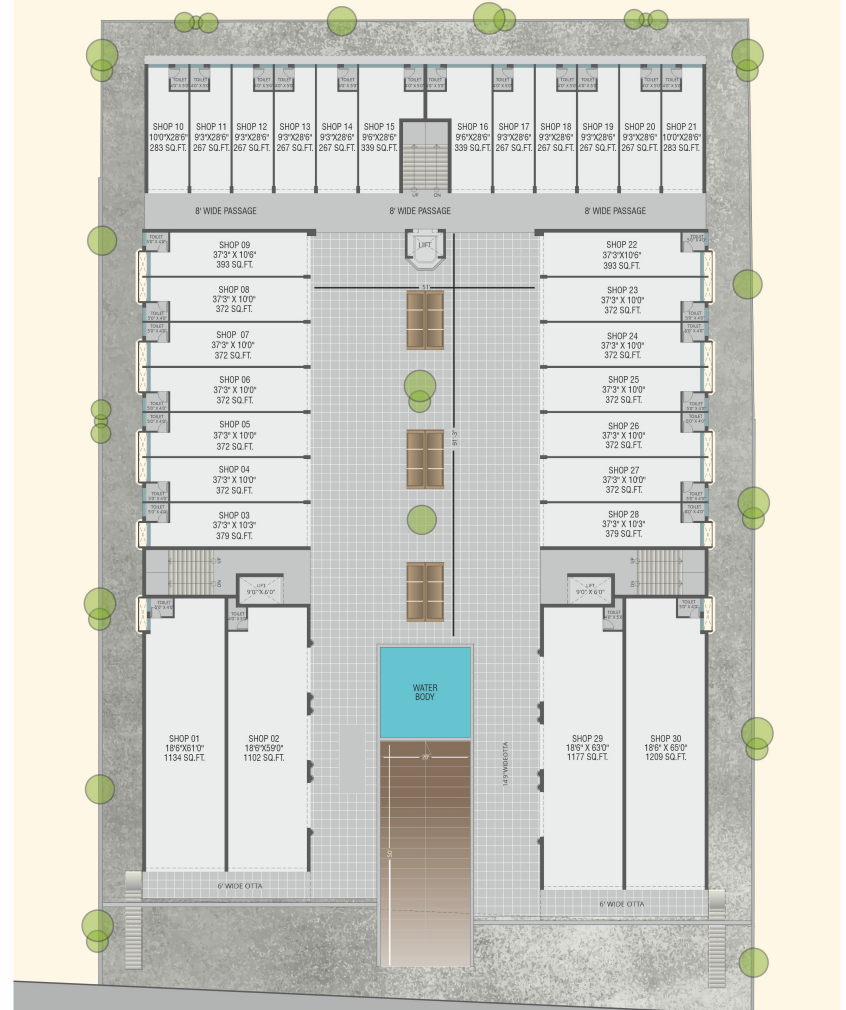

FIRST FLOOR PLAN

AMPLE SPACE

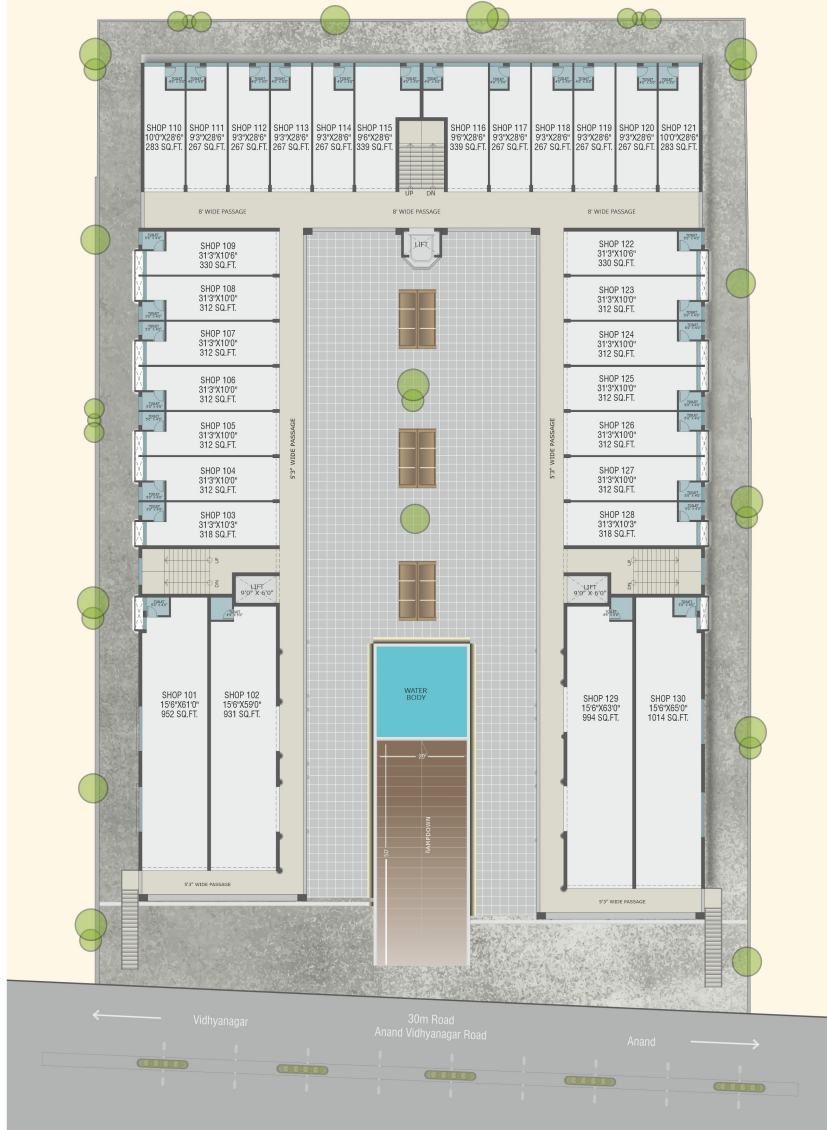

SECOND FLOOR PLAN

LUXURIOUS AMENITIES



THIRD FLOOR PLAN

LUXURIOUS AMENITIES

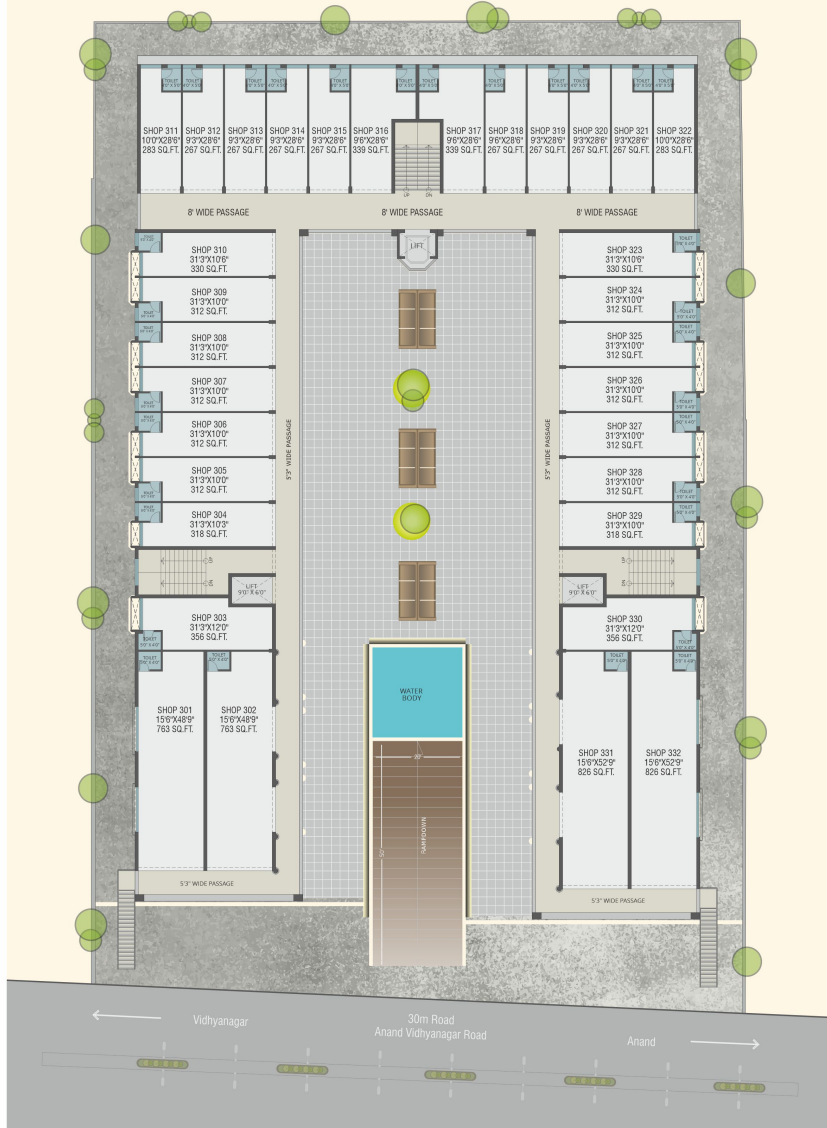

FOURTH FLOOR PLAN

LUXURIOUS AMENITIES

